

① School Reorganization:

10-1 On organization

10-2 All the Little bits

② Agenda

AGENDA

For meeting of the Council to be held in
the Council Chambers, Monday, February 8, 1954.
at 7:30 p.m.

PRESENT:

1. Confirmation of the minutes of the regular meeting of January 25, 1954.
2. UNFINISHED BUSINESS:
 1. Re Sale of land to Knox Church - Should we place a time limit on this sale.

3. CORRESPONDENCE:

- | | |
|------------------------------------|--|
| 1. R.D. Pistol & Rifle Club | Re: Purchase of piece of land behind Brewery |
| 2. Mr. Berry | Re: Purchase of land between Knox Church and Motor Car Supply for Theatre. |
| 3. Purnell and Sons | Re: Purchase of land between Knox Church and Motor Car Supply for theatre. |
| 4. Parks Superintendent | Re: Re his annual report, and Commissioner's questions on this. |
| 5. W. E. Lord | Re: Presbyterian Church property. |
| 6. Parsons, Wood, Lampard, & Kirby | Re: Re-subdivision of Lots 8 - 11 and 8a - 11a (incl.) of Block W |
| 7. Dominion Fire Commissioner | Re: Congratulations to R.D. Fire Dpt.s success in Fire Prevention Week. |

4. REPORTS:

1. Public Work's annual report for 1953.
2. Public Work's report of waterworks main extensions for 1953.
3. Fire Chief's report for January.
4. Recreation Commission meeting minutes.
5. Welfare Officer's report on Metro Mackoweechuk and Mr. Lewis.
6. Meat inspection report for 1953 (Animal Clinic)
7. Building permits for January
8. Proposed 1954 Budget for Recreation Commission.

5. NEW BUSINESS:

1. Payment of accounts. -
2. Re closing of toboggan slide. -
3. Agreement between City of Red Deer and R.D. Civic Employees Federal Union.
4. Agreement between City of Red Deer and International Brotherhood of Electrical Workers Local Union 348, Calgary, Alta.

5. Salaries

6. Salaries

7. Salaries

① Compared salaries in other municipalities
② Increased salary of some length with all concerned
③ Believe need salaries adjusted as proposed in order to retain interested & professional organizations

Salary - 465
Salary - 250

Over

55th



Parag

Plan



Stem

Leaves



[Faint, mostly illegible handwritten notes and sketches, possibly including a diagram of a plant stem with leaves.]

CORRESPONDENCE:
To Commissioners:

LETTER NO. 1

1.

Re: R.D. Pistol and Rifle Club

I see no objection to the sale of a piece of land measuring 75' by 125' behind the Brewery as indicated on the sketch below.

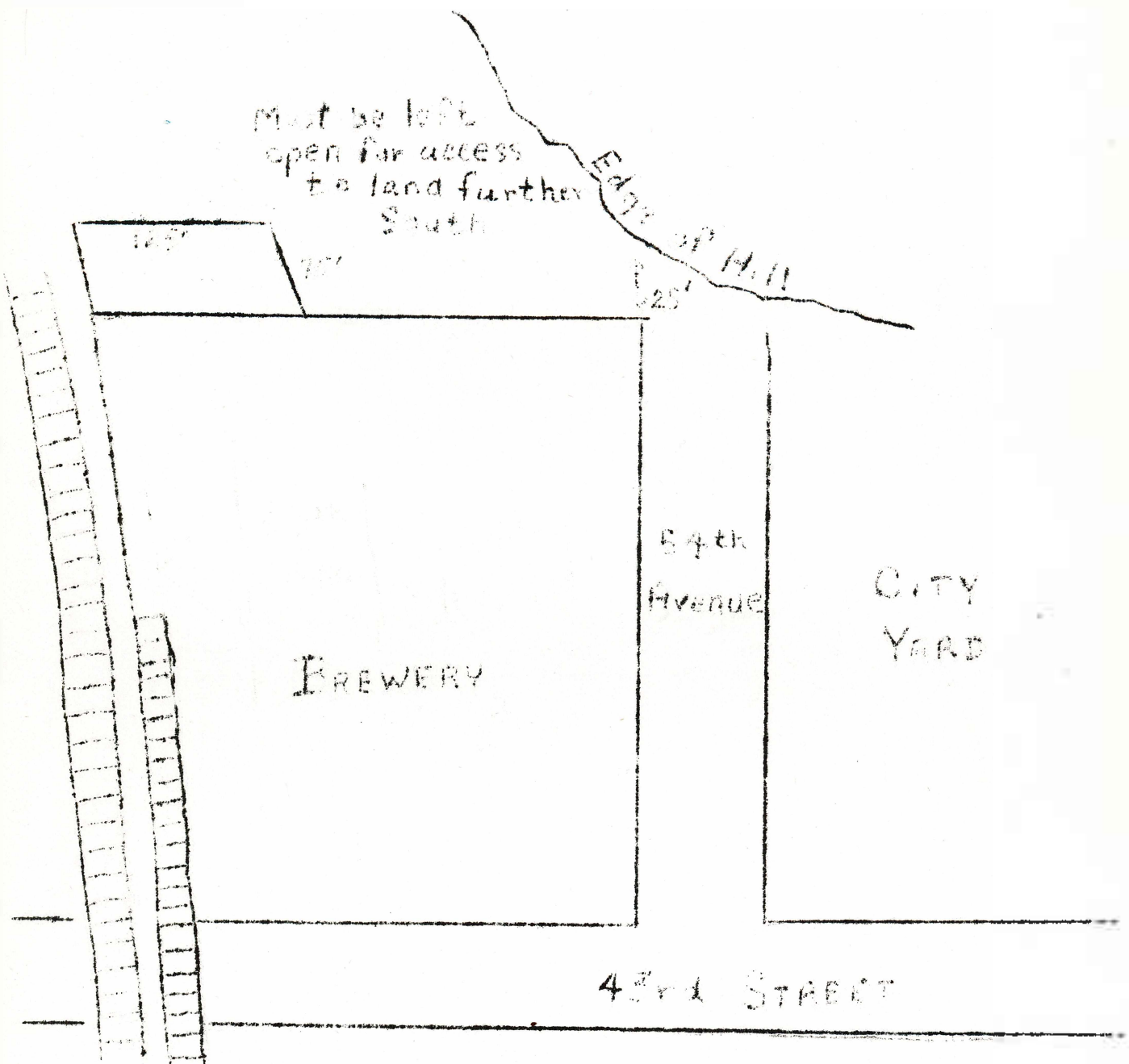

Building with extensions = 24' X 75'

Em:

My observations on application are attached. Would you please give yours with sale price.

Estimated value of initial improvements \$1,000.

"Denis"

I see no objection to this land being sold for this purpose.
Land Value - \$355.00 and cost of survey on the understanding that utilities as required will be paid for in full.

"C. E. Ross"

Red Deer City Council,
City of Red Deer.

3836 - 47 St.,
Red Deer, Alta.
Jan. 25, 1954

2.

Dear Sirs:

I am writing letter on behalf of the Red Deer Pistol and Rifle Club, to be presented as an application for the purchase of a parcel of land that would be suited to the construction of an indoor shooting range for pistols and 22 calibre rifles.

If our application is accepted, it is our intention to construct an underground range of concrete which will be 12 feet wide and 65 feet long. A second 20 feet portion of a range will be built with the intention of completing it at a later date.

The 20' X 24' section formed by the 20 feet portion of range #2 alongside range #1 will provide space for temporary club rooms.

A desirable site would be one directly south of the Red Deer Brewery property since it is quite apart from residential areas and service of gas and electricity, as well as parking space would be quite readily available.

Yours truly,
"J. Runge", President
RED DEER PISTOL AND RIFLE CLUB

NOTE: Could be present at meeting if required.
D.C.

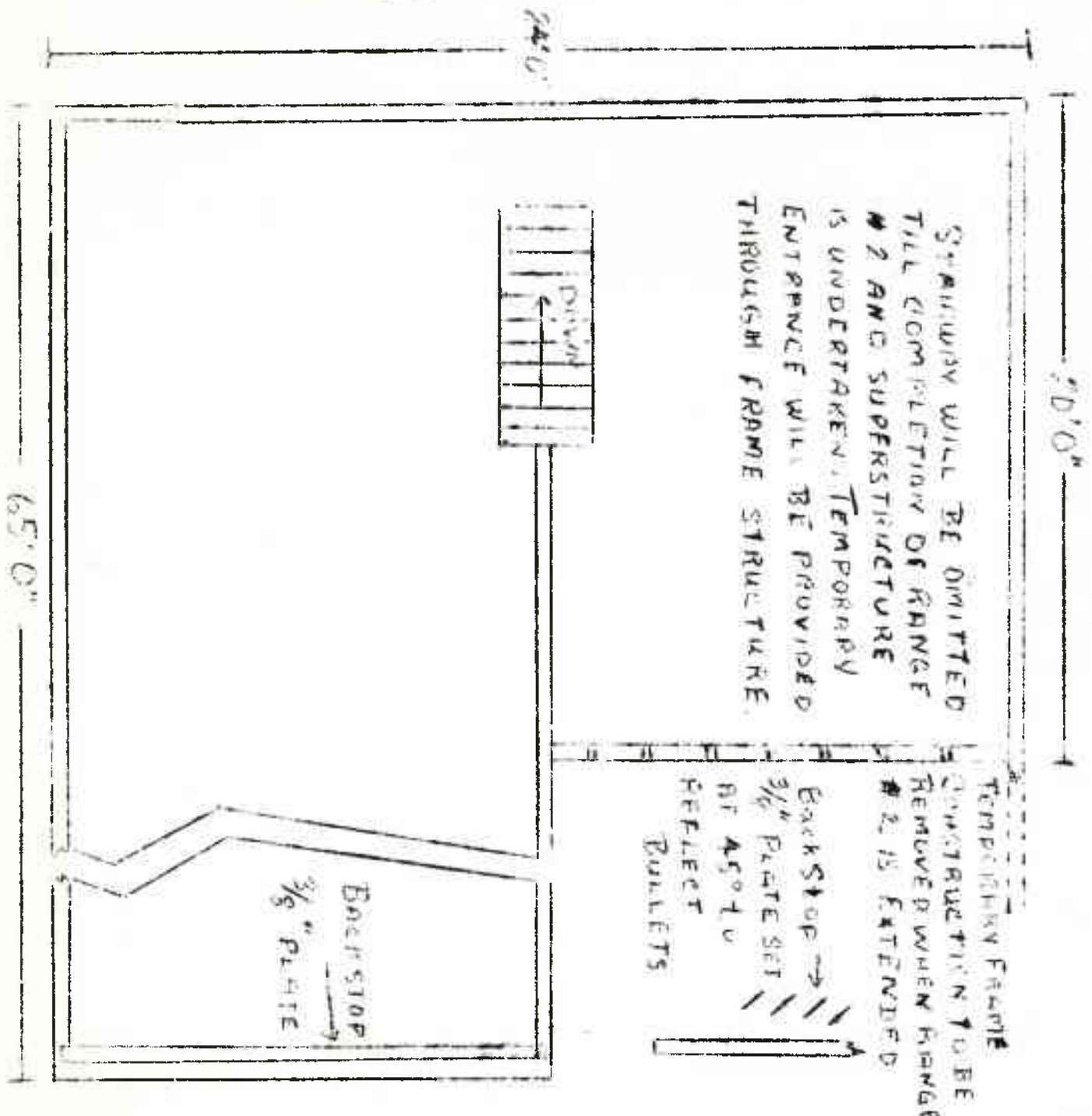

LETTER NO. 2

January 26, 1954

3.

E. Newman,
City Clerk.

Dear Sir:

Re: Purchase of land between Knox Church and Motor Car
Supply on 49 St., Red Deer

I wish to submit a bid on the above mentioned land on behalf of Mr. Berry of Calgary. The price of offer is \$11,500.00.

The improvements to be placed on the land will be a theatre with a seating capacity of 897 and the value of some \$200,000.00.

Trusting this offer will be given serious consideration as this project if approved will be underway as soon as the frost is out of the ground and plans, etc. have been approved by your building inspector, etc.

Yours truly,
"A. A. Ferris"

LETTER NO. 3

January 30, 1954

City Clerk,
City of Red Deer.

Dear Sir:

Re: Lots 21 & 22, Block 19, Plan H, Red Deer

We are pleased to submit for your consideration an offer to purchase the above described property for a cash consideration of \$12,000.00.

It is our intention, if our offer is accepted, to construct upon the property a stadium type theatre complete with the most modern and up-to-date facilities available at the present time.

The project will be undertaken by us in conjunction with Famous Players Canadian Corporation Limited. The estimated cost of the theatre is \$200,000.00. We should be pleased to furnish you with the proposed plan of the building together with any other information you may require.

We would respectfully bring to the attention of the City Officials and Council that inquiries were made by us at the City Office in the summer of 1952 as it was hoped at that time to acquire the property and commence construction of a theatre. At that time we were advised by the City Clerk it was not for sale due to a shortage of parking facilities, but we were given verbal assurance by the City Clerk that we would be given first opportunity to purchase the property if and when it became available to the public.

Yours respectfully,
PURNELL AND SONS
Per: W. Purnell

The City Clerk,
City of Red Deer.

February 5, 1954.

Dear Sir:

We hand you herewith complete set of plans with respect to a theatre proposed for construction by Messrs. Purnell and Sons.

Construction will be commenced in the Spring as soon as conditions permit. The seating capacity of the proposed theatre will be a minimum of 750 seats, with a maximum of 900 seats.

Yours truly,
PURNELL & SONS,
per "W. Purnell"

January 28, 1954

Mr. Beveridge,
City Commissioner.

Dear Sir:

The following is the answer to your questions dated January 27th, 1954.

No. 1 It is feasible to do some more work on the playgrounds with the present staff. General maintenance is being carried out by the department. New playgrounds are being levelled and seeded. I do not know the nature of any other work you may suggest.

No. 2 I am not in favour of stopping cars entering Gaetz Park. The under-brush is being cleared, dead trees are being taken out and we hope to be able to keep grass cut this summer. No place will be left where people can hold parties with out being seen from a distance. The City by-law allows the police to clear the park at 11:00 p.m.

No. 3 Money is being provided in the budget for maintenance of work already done at the Memorial Centre, also for construction of the proposed extension.

Yours truly,
"H. Gilchrist"
Parks Superintendent

LETTER NO. 5

February 4, 1954

Messrs. Harvey Halladay, Mayor,
and Aldermen,
City of Red Deer.

Gentlemen:

Whether the Presbyterian Church property finds its way to the tax roll depends on whether the Presbyterian Congregation has another place on which to build, and whether it has another place to build upon depends upon the action of the City Council, and the action of the City Council depends upon the information it has, and the information it has depends, in part, on what the City Commissioner is pleased to tell them.

I could have given the Council, at the last meeting of the Council the information contained herein, had I been permitted; and more, had the Council asked for it.

When I completed negotiation with the ~~XXX~~ Canadian National Railway Co. for the purchase of two triangles abutting on Ross Street, they advised that as an agreement with the City of Red Deer was involved, I should request the City of Red Deer to make application to purchase; and the City, in turn, would issue title for that which was required for the purpose of the Church.

I then advised the City accordingly, and the City proceeded promptly from there, the gate having been opened.

I suggested we should sell the triangle on the south side of the Street to Safeway for sufficient to cover the total cost, and consequently I should have to pay nothing.

The City offered it to Safeway for \$1,800.00 but Safeway did not indicate any interest in the offer, and, consequently, the offer was withdrawn.

The area originally designated for the Church was 188 feet deep, being .434 of one acre. The area which is now available is reduced to a depth of 125 feet, equal to .289 of one acre; valued at \$2,500.00 per acre amounts to \$702.15; and adding back charges of \$680.00, makes a total of \$1,382.15.

I am willing to complete the original proposition, even for the reduced area; but I am unwilling to be held up for an amount of over \$4,000.00, simply because I incurred the displeasure of one of the City Officials when I commented on the Interceptor System in the City Office. I will attend the meeting of the Council on Monday evening, that you may have opportunity of interrogation, should you so desire.

Yours very truly, "W. E. Lord"

January , 1954.

To the Commissioners
and City Council of Red Deer.

Gentlemen:

The western and northern treed slopes of Michener Hill provide Red Deer with an attractive scenic frame of sylvan beauty which has been enjoyed by many citizens, past and present. The time has come when the City should have the partial control now exercised through stipulations written into property titles regarding the defacing of the hillside.

The undersigned taxpayers own 385 feet, in width, of the Michener Hill property, and wish to offer the western and northern hillside portions of these lots to The City of Red Deer as a free gift. This offer would be contingent upon the City canvassing the small number of other property holders involved and having all agree to donate the hill portions of their lots, in return for which we would expect a binding promise from the City that the donated land would be preserved for all time as a park strip.

We hope you will investigate this matter and arrange a meeting of the affected taxpayers to discuss the plan.

Yours truly,
"R.M. Parsons, M.D."
"Kerry Wood".

5120-43 Ave.,
Red Deer, Alta.,
January 7, 1954.

City Commissioner,
City of Red Deer,
Alta.

Dear Sir:

re: Re-subdivision of Lots 8 - 11 and
8a - 11a (incl.) of Block W

Please consider this as our application for permission to build Apartment Blocks on Blocks E and F of the enclosed sub-division of Lots 8 - 11, said buildings to be set back ten feet from the west edge of the property. We understand that this was agreed to in Council, in 1953.

Yours truly,
" J.A. Lampard"
for: Kirby & Lampard.

NOTE:

Jim: Sub-division as shown on plan is approved by J.B. Commissioner, apartments would be permitted but By-law 1341 (6) (4) requires front yard of not less than 20' depth.

"D.C."

January 25, 1954.

6.

Mr. A.G. Taylor,
Chief, Fire Department,
RED DEER, Alta.

Dear Chief:

On behalf of the Dominion Fire Prevention Association, I would like to take this opportunity of extending to you my heartiest congratulations on your success in obtaining 1st Place in Class C in your Province in the International Fire Prevention Week competition conducted by the National Fire Protection Association.

I trust that your efforts in this campaign will result in a lower fire loss in your municipality during the year.

Yours truly,
"C.A. Thomson"
Executive Officer, D.F.P.A.
Dominion Fire Commissioner.

To the Commissioners,
City of Red Deer.

Gentlemen:-

I am pleased to present the following report on the activities of the Public Works Department for 1953.

WATERWORKS MAINTENANCE

Filter Plant

The various storage tanks of the filter plant were scrubbed down and sterilized with chlorinated lime.

The filter beds were washed and chemically treated to remove color from the sand.

The inside of the building and all exposed piping was washed and painted.

Wells

The wells were cleaned twice, once before the spring run-off and again after the high water in June.

The screens were cleaned out and new cinders put in.

The pumps had to be pulled and repaired several times, due to dirty water causing excessive wear in the bronze bushings.

Intake

After the breakdown of the old intake pipe, in 1952, we were instructed to build an open-channel type of intake. This was done, and there was no further trouble.

Distribution System

Some trouble was experienced with a Transite line in West Park. The pipes were breaking about midway between the ends, for no apparent reason. After examining several of these pipes, we made a greater allowance for expansion and had no further trouble. Aside from this one line, we have had less than the usual number of bad leaks.

All hydrants were greased and the packings and valves checked, in the late fall. During the winter a continued check is carried out to locate and repair frozen or faulty hydrants.

The flooring of the reservoir on Michener Hill is in very bad condition and will require renewing in the near future.

Street Maintenance

The Streets required a great deal of work to keep them barely passable during the long rainy spell in the spring. About 5000 cu. yds. of rough gravel was hauled into the various mud holes. Those roads north of the river, where new ditches had been dug, were particularly bad.

The graders were kept busy during the summer, but the results were poor. Most of the unpaved streets are worn down to the base, and little, if any surface gravel is left for the graders to work on.

As soon as weather permitted the paved streets were patched with asphalt.

Garage & Yard Maintenance

A concrete floor was poured in the addition to the City Garage on 48 St.

The trees were removed from the West & South of the Yard on 43 St., in preparation for extending the yard.

A new building was erected, to be used as a store for some of the Electric Light Department supplies, and as an office for the Storeman.

The old buildings were sided to match the new, and the fence was painted.

DRAINAGE MAINTENANCE

Culverts

On 59 Street, at Lane West of 52 Avenue - 6" pipe
 On lot 23, Springbett Drive - 15" pipe
 On 50 Avenue, at Waskasoo Creek - relief outlets from catch basins to creek.
 At Hillcrest Store, from catch basin to ditch along Highway #2.

Drainage ditches & culverts were cleaned out on South Hill, West Park and North Red Deer.

A drainage ditch was dug parallel to 55 Street, from 43 Avenue Eastward to the foot of the hill.

Catch Basins were built -

On the land North of 37 Street, at the junction with 37 St.
 on 45 Avenue, 80 feet North of 53 Street.
 At Hillcrest Store
 37 Street & 43 Avenue (old basins brought to grade)
 44 Avenue at 58 Street - 2
 51 Avenue at 60 Street - 1
 51 Avenue at 59 Street - 2
 52 Avenue at 59 Street - 2
 54 Avenue at 43 Street - 2

STREET CONSTRUCTION

Some of roads, serving newly built-up areas, required a considerable amount of fill to bring them up to grade.

Following is a list of streets principally affected, with approximate amounts of fill material -

44 Avenue, N. of 37 Street	200 cu. yds.
45 Avenue, S. of 37 Street	1900 cu. yds.
43 Avenue, S. of 37 Street	450 " "
35 Street, E. of 42 Avenue	1000 " "
44 Street, 43 Ave. to 42 Ave.,	300 " "
46 Street, 41 Ave., to 40 Ave..	350 " "
41 Avenue, Ross to 52 St.	2350 " "
51 Street, 42 Ave., to 40 Ave.	2600 " "
50 A. Street, 39 Ave. to 40 Ave.	1100 " "
52 Street, 42 Ave. to 40 Ave.	200 " "
43 Street, CPR to 54 Ave.	800 " "
45 Ave., 58 St. to 59 St.	500 " "
N. Side of Ross, at Alton Bros.	1100 " "
42 Avenue at 53 Street	1300 " "
51A Street, 41 Ave. to 40 Ave.	250 " "
Road through old Auto Park	700 " "
Crossing, 58 Street at CPR	200 " "
49 Avenue, 33 St. to 34 Street	1100 " "
59 Street, 52 Ave. to 53 Ave.	1000 " "
Lane East of Springbett Drive	200 " "

A surface course of 1 1/2 inch crushed rock was applied, to a depth of three inches, on the following streets -

45 Avenue, from 58 Street to 59 St.
 42 Avenue, from 53 Street to 55 St.
 51A Street, from 40 Avenue to 41 Avenue
 51 Street, from 40 Avenue to 41 Avenue
 41 Avenue, from Ross Street to 52 Street
 46 Street, from 41 Avenue to 43 Avenue

These streets are now ready to for stabilizing next spring.

WATERWORKS CONSTRUCTION

41 Avenue	44 Street	46 Street	608 ft. 6 inch mechanical joint
57 Avenue	60 Street	Northward	304 ft. 4 inch Bell & spigot
54 Avenue	59 Street	60 Street	448 ft. 4 inch Bell & spigot
55 Avenue	C.P.R.	N. of 60 Street	432 ft. 4 inch Bell & spigot
60 Avenue	54 Avenue	58 Avenue	1,280 ft. 6 inch Bell & spigot
56 Avenue	C.P.R.	N. of 60 Street	576 ft. 4 inch Bell & spigot
58 Avenue	60 Street	60 A street	320 ft. 6 inch Bell & Spigot
60 Street	58 Avenue	60 Avenue	816 ft. 6 inch Bell & spigot
60 A Street	58 Avenue	59 Avenue	492 ft. 6 inch Bell & spigot
Springbett Drive	End of main 1952	N. of 39 Street	400 ft. 6 inch Bell & spigot
47 Street	40 Avenue	41 Avenue	464 ft. 6 inch Bell & spigot
55 Avenue	37 Street	39 Street	675 ft. 6 inch Transite
37 Street	55 Avenue	56 Avenue	423 ft. 6 inch Transite
38 Street	54 Avenue	55 Avenue	533 ft. 6 inch Transite
51 A Street	40 Avenue	41 Avenue	416 ft. 6 inch Bell & spigot
Lane N. of Ross	39 Avenue	40 Avenue	608 ft. 6 inch mechanical joint
Lane E. of 49 Ave.	33 Street	34 Street	540 ft. 6 inch Bell & spigot
58 A Street	58 Avenue	59 Avenue	443 ft. 6 inch mechanical joint
54 Avenue	43 Street	North to Transit-mix	288 ft. 8 inch Bell & spigot
56 Avenue	39 Street	Southward	112 ft. 6 inch mechanical joint
56 Avenue	39 Street	41 Street	576 ft. 6 inch mechanical joint
41 Avenue	35 Street	Northward	48 ft. 6 inch mechanical joint
42 Avenue	Between 35 Street & 36 Street	Southward	64 ft. 6 inch mechanical joint
53 Avenue	55 Street	Southward	496 ft. 8 inch mechanical joint
53 Avenue	55 Street	Southward	424 ft. 8 inch Bell & spigot
39 Street	54 Avenue	55 Avenue	568 ft. 6 inch Transite
35 Street	42 Avenue	East of 41 Avenue	752 ft. 6 inch mechanical joint
At the Arena site,	from the Fire Station West to the Curling Rink	41 Street	736 ft. 6 inch mechanical joint
55 Avenue	39 Street	39 Street	554 ft. 6 inch Transite
56 Avenue	41 Street	57 Avenue	576 ft. 6 inch mechanical joint
37 Street	55 Avenue	38 Street	351 Ft. 6 inch transite
55 Avenue	39 Street	54 Avenue	338 ft. 6 inch transite
38 Street	55 Avenue	56 Avenue	533 ft. 6 inch transite
From 39 Street, between 43 Avenue and 44 Avenue, North to Lancasters			453 ft. 6 inch mechanical joint
41 Street	55 Avenue		351 ft. 6 inch Transite
44 Avenue	39 Street North to Saxby property		276 ft. copper tubing
39 Street	44 Avenue	40 Avenue	1,920 ft. 6 inch mechanical joint

SEWER CONSTRUCTION 1953

Serial	Location	From	To	Length	Size & Type of Pipe
1	On 40 Avenue	50 Street	(Lane North)	168 ft.	8" Concrete tile
2	On 43 A Avenue	39 Street	700' North	700 ft.	
3	On 53 Avenue	55 Street	1148	1148 ft.	425' of 15"-723' of 12"
4	On 55 Avenue	37 Street	39 Street	674 ft.	
5	On 55 Avenue	C.P.R. Mainline	60 Street	337 ft.	8" vitrified tile
6	On 56 Avenue	C.P.R. Mainline	100' N. of 60 Street	430 ft.	575' 8" vitrified tile
7	On 57 Avenue	C.P.R. Mainline	150' N. of 60 Street	477 ft.	
8	On 58 Avenue	60 Street	60 A Street	348 ft.	370' 12" vitrified tile
9	On 34 Street	Lane E. of 50 Ave. to lane E. of 49 Ave. & South on lane to 33 Street		915 ft.	
10	On 37 Street	54 Avenue	55 Avenue	566 ft.	10" concrete tile
11	On 37 Street	55 Avenue	57 Avenue	852 ft.	8" concrete tile
12	On 38 Street	54 Avenue	55 Avenue	566 ft.	10" concrete tile
13	On 39 Street	40 Avenue	43 Avenue	1200 ft.	10" vitrified tile
14	On 39 Street	44 Avenue	43 Avenue	800 ft.	10" concrete tile
15	On 47 Street	40 Avenue	41 Avenue	463 ft. & 38	12" vitrified tile
16	On 50 Street	40 Avenue	41 Avenue	466 ft.	10" concrete tile
17	On lane S. of 50A St.	39 Avenue	40 Avenue	599 ft.	618' 8" concrete tile
18	On 51 Street	40 Avenue	41 Avenue	466 ft.	
19	On 55 Street	42 Avenue	45 Avenue	1697 ft.	12" concrete tile
20	On 58A Street	58 Avenue	59 Avenue	491 ft.	
21	On 60 Street	54 Avenue	58 Avenue	1377 ft.	1402' 12" vitrified tile
22	On 60 Street	58 Avenue	60 Avenue	838' ft.	12" vitrified tile
23	On 60A Street	58 Avenue	59 Avenue	473 ft.	8" vitrified tile
24	On Springbett Drive	End of the line	North to 39 St. & 44 Ave.	325 ft.	
25	On 41 Street	55 Avenue	56 Avenue	351 ft.	10" concrete tile
26	On 55 Avenue	39 Street	38 Street	339 ft.	10" concrete tile
27	On 56 Avenue	39 Street	Southward	80 ft.	10" vitrified tile
28	On 56 Avenue	39 Street	41 Street	501 ft.	10" concrete tile
29		39 Street, between 43 & 44 Ave.	North to Lancasters	453 ft.	8" concrete tile
30	On 44A Avenue	39 Street	Northward	276 ft.	6" vitrified tile
31	On 35 Street	42 Avenue	41 Avenue	567 ft.	8" concrete tile
32	On 42 Avenue	Extension south	35 Street	39 ft.	8" concrete tile
33	On 54 Avenue	59 Street	60 Street	585 ft.	12" vitrified tile
34	On 55 Avenue	60 Street	Northward	165 ft.	8" vitrified tile
35	On 51 A Street	41 Avenue	40 Avenue	338 ft.	8" vitrified tile
36	52 Street	Extension Eastward		65 ft.	12" Ringtite
37	On 39 Street	54 Avenue	55 Avenue	535 ft.	12" vitrified tile
38	On 39 Street	43 Avenue	42 Avenue	430 ft.	10" vitrified tile

MANHOLE CONSTRUCTION 1953

1.	37 Street at 54 Avenue	27.	55 Avenue at lane South
2.	37 Street at 55 Avenue	28.	56 Avenue, at lane South
3.	37 Street at 300' E of 55 Avenue	29.	60 Street at 55 Avenue
4.	38 Street at 54 Avenue	30.	60 Street at 56 Avenue
5.	38 Street at 300' E of 55 Avenue	31.	60 Street at 57 Avenue
6.	38 Street at 55 Avenue	32.	60 St. at 58 Ave. S side of St.
7.	37 Street 250' W 56 Avenue	33.	60 St. at 58 Ave. N. side of St.
8.	37 Street at 56 Avenue	34.	60 Street of 59 Avenue
9.	37 Street at 57 Avenue	35.	60 Street at 60 Avenue
10.	56 Avenue at 41 Street	36.	60 A Street at 58 Avenue
11.	56 Avenue 300' S of 41 Street	37.	60 A Street at 59 Avenue
12.	56 Avenue at 39 Street	38.	51 A Street at 40 Avenue
13.	453' N of 39 St. on line to Lancasters	39.	44 Avenue at 58 Street
14.	39 Street, 361' E of 43 Avenue	40.	45 Avenue at 53 Street
15.	39 Street of 43 Avenue	41.	40 Avenue at 52 Street
16.	40 Avenue of 35 Street	42.	39 Street at 54 Avenue
17.	41 Avenue at 35 Street	43.	39 Street, 300' E 55 Avenue
18.	42 Avenue at 35 Street	44.	53 Avenue at 55 Street
19.	East end of Springbett Drive	45.	53 Avenue at 54 Street
20.	581' E of 40 Ave., in lane N of Ross	46.	53 Avenue, 158' S of 54 St.
21.	150' E of 40 Ave., lane N of Ross	47.	53 Avenue 335' N of 53 St.
22.	40 Ave., at lane N. of Ross	48.	53 Avenue at 53 Street
23.	235' E of E of 40 Ave. lane N of Ross	49.	58A Street
24.	40 Avenue at Ross Street	50.	58 A Street
25.	54 Avenue at 60 Street	51.	58 Avenue
26.	54 Avenue, 267' S of 60 Street	52.	58 Avenue

SIDWALK CONSTRUCTION 1953

<u>NO</u>	<u>TYPE</u>	<u>ON</u>	<u>FROM</u>	<u>TO</u>	<u>LENGTH</u>	<u>AREA - SQ. FT.</u>
1.	4' walk	W/side 44 Ave.	35 St.	37 St.	553'	2,212
2.	4' walk	S/side 37 St.	44 Ave.	West	240'	960
3.	4' walk	S/side 43 St.	50 Ave.	52 Ave.	1,266'	5,064
4.	4' walk	E/side 49 Ave.	48 St.	49 St.	300'	1,200
5.	4' walk	E/side 51 Ave.	37 St.	39 St.	607'	2,428
6.	4' walk	S/side 39 St.	51 Ave.	52 Ave.	432'	1,728
7.	4' walk	S/side 50 A St.	41 Ave.	42 Ave.	432'	1,728
8.	4' walk	N/side 50A St.	41 Ave.	42 Ave.	432'	1,728
9.	4' walk	S/side 51 St.	41 Ave.	42 Ave.	432'	1,728
10.	4' walk	N/side 51 St.	41 Ave.	42 Ave.	432'	1,728
11.	4' walk	S/side 51 A St.	41 Ave.	42 Ave.	432'	1,728
12.	4' walk	N/side 51 A St.	41 Ave.	42 Ave.	432'	1,728
13.	4' walk	S/side 52 St.	40 Ave.	41 Ave.	432'	1,728
14.	4' walk	S/side 52 St.	41 Ave.	42 Ave.	432'	1,728
15.	4' walk	E/side 42 Ave.	50 A St.	51 St.	302'	1,208
16.	4' walk	E/side 42 Ave.	51 St.	51 A St.	302'	1,208
17.	4' walk	E/side 42 Ave.	51A St.	52 St.	130'	520
18.	4' walk	E/side 42 Ave.	53 St.	55 St.	755'	3,020
19.	4' walk	W/side 42 Ave.	53 St.	55 St.	755'	3,020
20.	4' walk	S/side 43 St.	52 Ave.	54 Ave.	851'	3,404
21.	4' walk	W/side 41 Ave.	50 St.	52 St.	1,173'	4,692
22.	4' walk	N/side 51 A St.	42 Ave.	43 Ave.	268'	1,072
23.	4' walk	S/side 51 A St.	42 Ave.	43 Ave.	268'	1,072
24.	5' walk	S/side 35 St.	49 Ave.	East	150'	750
25.	5' walk, C&G	S/side Ross	48 Ave.	47 Ave.	860'	4,330
26.	Curb & Gutter	N/side 49 St.	Lot 19, BlkA	Lot 23		
27.	4' walk	S/side 59 St.	50 Ave.	54 Ave.	1,024'	3,200- 220 lin.ft.
28.	5' walk	W/side Gactz	42 St.	South	500'	2,500 not complete
29.	4' walk	N/side 53 St.	42 Ave.	42 A Ave.	312	1,248
30.	4' walk	S/S 55 St.	Lane E of 42 Ave.	Lane E of 42 A Ave.	292	1,168
31.	4' walk	39 St.	50 Ave.	51 Ave.	100'	400
	4' walk	44 St.	in front of	South School	190'	760
	4' walk	44 Ave.	37 St.	250' W	250'	1,000

16,586lin. 65,358 sq. ft.
ft.

The following walks were not laid, for the reasons stated -

4' walk	E/S 42 Ave.	Ross St. to 50 A Street)	Pending a decision on
4' walk	N/S Ross	45 Avenue to 42 Avenue)	the reconstruction of
4' walk	N/S Ross	42 Avenue to 41 Avenue)	Michaner Hill.
10' walk, C&G	W/S Cactz	49 Street to 50 Street	- too cold.

This report is respectfully submitted,
 "L.R. Taylor"
 Public Works Superintendent

The Commissioners,
City of Red Deer.

Gentlemen:-

We are herewith submitting our report of waterworks main extensions carried out during 1953.

One of the main features of last year's programme was the use of mechanical joint pipe. While the cost of this type of pipe is higher in initial price than standard belt and spigot, the cost of laying it saved somewhat more than the difference in the cost of the pipe. It is recommended that this type of pipe be used as much as possible in the future.

The average costs of laying water mains (including materials) of various sizes and types during 1953 are as follows:-

4" cast iron (standard joint)	- \$3.42 —
6" cast iron (mech. joint)	- 4.58 —
8" cast iron (mech. & standard)	6.85 —
6" Transite	- \$4.68 —

The average cost for all water main laid during the past year was \$4.60 per lin. ft. The average cost for laying standard 6" belt and spigot pipe during 1952 was \$4.86 per lineal foot.

NOTE: The cost of laying transite shown above, includes 544' which was completed last January and raised the average cost of this type of pipe by 22¢ per lin. foot. The reason for this extra cost was the fuel required for burning ditches and digging through frozen ground.

As shown on the attached sheet, there was a total of 15,776 lin. ft. of water main laid during 1953. This is the largest amount of water main laid in the city within any one year.

The breakdown according to sizes and type are:-

4" cast	- 1456'
6" cast	- 9803'
8" cast	- 1208'
6" transite	- 3023'
1" copper	- 276'
TOTAL	<u>15,776'</u>

Last year, it was approved to levy a special frontage assessment of 22¢ per lineal foot for 20 years on all properties abutting new construction. This is the first year such an assessment has been made on water main extensions. The reason for levying this special assessment was to reduce the amount of debt payable from general revenue. Following is a list of properties affected by this assessment.

<u>Project #</u>	<u>LOCATION</u>	<u>LENGTH</u>	<u>SIZE</u>	<u>COST</u>
1	on 60A St. - 58 to 59 Ave.	492'	6"CI	2376.54
2	on 60 St. - 58 to 60 Ave.	416'	6"CI	4334.04
3	on 58 Ave. - 60 to 60 A Sts.	320'	6"CI	1537.66
4	on 60 St. - 54 to 58 Ave.	1280'	6"CI	6697.70
5	on 57 Ave. - from 60 St. 304' North	304'	6"CI	1117.05
6	on 56 Ave. - from C.P.R. to 60 St.	306'	4"CI	794.95
7	on 56 Ave. - from 60 St. 270' North	270'	4"CI	668.29
8	on 55 Ave. - from C.P.R. to 60 St.	288'	4"CI	1524.21
9	on 55 Ave. - from 60 St. 144' North	144'	4"CI	498.85
10.	on 54 Ave. - from 60 St. 448' South	448'	4"CI	1486.03
11	on 39 St. - 54 Ave. to 55 Ave.	568'	6"TH	2683.57
12	on 55 Ave. - 37 St. to 39 St.	676'	6"TH	2832.75
13	on 37 St. - 55 Ave. to 56 Ave.	351'	6"TH	1882.02
14	on 41 St. - from 55 Ave. to 56 Ave.	351'	6"TH	1537.13
15	on 56 Ave. - from 39 St. 41' St.	576'	6"CI	2160.47
16	on 56 Ave. - from 39 St. 64' south	64'	6"CI	799.46
17	on 38 St. - 54 Ave to 55 Ave.	533'	6"TH	2113.35
18	on 54 Ave. - from 43 St. 288' north	288'	8"CI	2177.23
19	on 35 St. - from 41 Ave. to 42 Ave.	752'	6"CI	3759.83
20	on 39 St. from 40 Ave. to 44 Ave.	1920'	6"CI	7996.66
21	on 44 Ave. - from 39 St. 276' north	276'	1"Cu.	291.18
22	on 43 A Ave. - from 39 St. 453' North	453'	6"CI	1908.72
23	from main in fairgrounds to lane between Arena & curling rink, thence along lane to front of Arena	730'	6"CI	3454.13
24	on 41 St Ave. - 44 St. to 46 St.	608'	6"CI	2191.47
25	on 47 St. - 40 Ave. to 41 Ave.	464'	6"CI	1962.71
26	on 51 A St. - 40 Ave. to 41 Ave.	416'	6"CI	1898.84
27	on lane H. of Ross St. - 39 to 40 Ave.	608'	5"CI	2738.45
28	on 53 Ave. - from 55 St. 920' south	920'	8"CI	6089.21
	on 55 Ave. - 39 St. to 41 St.	554'	6"TH	3125.01
TOTALS		15,776'		72,636.61

3155.2
3155.2
3470.72

72
72
1509.5

Fire Chief's Report,
February 1, 1954

His Worship the Mayor
and City Council

Gentlemen:

I wish to report that during the month of January, 1954 the Fire Department had two calls, one in the country and one city call.

January 6, 9:40 p.m.

Call came in from the residence of T. Miner, 6011 - 53 A St., Truck, sprinkler and 17 men turned out. Fire was in garage sized shed and was being used as sleeping quarters for owners sons; the fire had started from overheated stove pipes from coal and wood stove.

Shed was destroyed; Mr. Miner was charged \$30.60 for this call.

January 26, 9:10 p.m.

Call came in from residence of D. Yuill, 4602 - 51 St. stating there was smoke coming from his wall in the basement. As most of the firemen were here the siren was not turned on. One truck and 23 men answered call. Overheated vent pipe from gas heater had started wall smoldering in basement. Department had to chop small hole and used 5 gallon pump tank to extinguish fire. Damage slight.

On January 25, Fireman G. Mann went to Edmonton to attend a two-week C.D. Course in Rescue work.

The Department held its regular Tuesday night practises with an average attendance of 24 members present.

For Fire Prevention activities for 1953 Red Deer placed 1st in Class C for the province of Alberta, beating out Jasper Place and Medicine Hat. This is the first year that Red Deer has been in Class C which covers population from 10,000 to 25,000 and I am very pleased that through the efforts of the men of the department we were able to take 1st place in our first year of being in a higher group.

Respectfully submitted,
"W.N. Thomlison"
Fire Chief

RECREATION COMMISSION MEETING - CITY HALL - FEB. 1, 1954

Present were: Dr. Fleming, Mayor Halladay, H. Bilchrist, R.B. Gish, A. Evans, F. Nielsen, E.M. Castella, Mrs. T. Foster, T. Cornett, C.M. Ward, Miss A. Olsen, E.C. Ross, C.J. Miller.

J. Lampard, B. Woodrow, H. Webb. W. Code were absent from the meeting.

Meeting opened at 8.10 p.m. with Dr. Fleming in the chair. Minutes of the previous meeting were approved as transcribed.

Mayor Halladay spoke re liability insurance held by the City and stated that as yet he had not the information as to how this coverage would affect sponsors of individual teams. He hoped to have something further on this for the March meeting of the Commission.

Mr. Nielsen reported that plans were going ahead for the proposed "Kid's Night" and that a detailed programme would be presented to the next meeting. March 19th was set as night for this event with a charge of 50¢ for adults, children free. Above on motion of Gish and Nielsen.

Dr. Fleming reported the Friendship Club was away to a good start and now had a membership of over 80.

Mr. Gish reported that Ski Club was using ski tow at Innisfail and that nothing further would likely be done here until a more suitable hill was found.

Annual Commission Budget was presented to the meeting and after a few minor changes was accepted by the meeting in the sum of \$1,5210.00. On motion of Fleming and Castella the Secretary was requested to present same to City Council.

Commission voted necessary expense money to Director to attend Conference of National Recreation Association in Spokane on March 28-29-30-31.

Meeting adjourned at 9.30 p.m.

Welfare Officer's Report,
January 21, 1954

The Commissioners,
City of Red Deer.

Gentlemen:

My personal interview with Metro Mackowecchuk and Mr. Lewis is as follows:

Mr. Lewis said he was waiting for a letter from the city office, as he was unable to go to the tax meeting, and he also heard that the taxes would not be as high as most people had figured. If that were true he'd be able to take care of same, but if his taxes proved to be much more than last years taxes, he'd let us know.

Metro Mackowecchuk said his mother in whose name the house he and his wife Eileen now live in is at present living in Edmonton. with another son, and that Metro and Eileen were the ones who wrote the letter disputing the Assessment notice thinking according to their figures the taxes on his mother's property were going to be too high and take approximately four months rent to cover same. One checking with his brother, they have decided to take care of the taxes between them.

I do hope this covers the information you wanted.

I am at your service always,
"Vera Russell"
Welfare Officer

City Commissioners,
City of Red Deer.

Animal Clinic,
5606 - 51 Ave.
Red Deer, Alta.

Dear Sirs:

Please find attached a chart covering the meat inspections carried out in 1953. I believe the chart is self explanatory and needs no further comment.

Yours truly,
"R. Walton"

1953	Animal Inspected	Number Inspected	Number of Portions Rejected	Reason for Rejection	Number of Carcasses rejected	Reason for Rejection
January	Hogs	44	2	T.B.		
	Beef	9				
	Veal	2				
	Sheep	12				
February	Hogs	42				
	Beef	12	1	Abscess		
	Veal	4				
	Sheep	12				
March	Hogs	43	3	T.B.	1	Jaundice
	Beef	12				
	Veal	3				
	Sheep	10				
April	Hogs	44				
	Beef	10	2	Abscess		
	Veal	4				
	Sheep	12				
May	Hogs	42	2	T.B.		
	Beef	12				
	Veal	4				
	Sheep	12				Broken leg
June	Hogs	44	2	T.B.		
	Beef	14				
	Veal	3				
	Sheep	9				

(continued)	Animal	Number	Number of	Reason	Number	Reason	18.
<u>1953</u>	<u>Inspected</u>	<u>Inspected</u>	<u>Portions</u>	<u>for</u>	<u>of Carcasses</u>	<u>for</u>	
			<u>Rejected</u>	<u>Rejection</u>	<u>Rejected</u>	<u>Rejection</u>	
July	Hogs	18					
	Beef	5					
	Veal	0					
	Sheep	0					
August	Hogs	36					
	Beef	12					
	Veal	3					
	Sheep	4					
September	Hogs	42	3	T.B.			
	Beef	14					
	Veal	4					
	Sheep	8					
October	Hogs	40	2	T.B.			
	Beef	10	1	Abscess			
	Veal	3					
	Sheep	10					
November	Hogs	44	2	T.B.			
	Beef	12					
	Veal	4					
	Sheep	12					
December	Hogs	40					
	Beef	10					
	Veal	5					
	Sheep	10					

BUILDING PERMITS

January, 1954

<u>NAME</u>	<u>DESCRIPTION</u>	<u>AMOUNT</u>
J. C. Porlick	suite in bsmt.	\$1000.00
Ray Tucker	" " "	350.00
	TOTAL	1350.00

NEW BUSINESS:

Mr. Rattenbury of Oswald, Hammond, and Manton requested that the tobaggan slide be closed or properly supervised. His Worship has ordered this closed as from February 4 and the final decision rests with Council.

February 5, 1954.

The Mayor & Council,
City of Red Deer,
RED DEER, Alta.

Gentlemen:

Attached is proposed 1954 Budget for Recreation Commission as approved at their regular meeting on February 1, 1954.

Any queries re budget can be answered by Mayor Halladay or myself as members of the budget committee.

Yours truly,

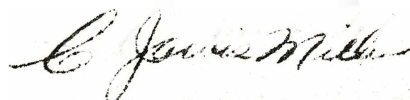

C. Jarvis Miller,
Secretary.

CJM:lw
Att.

RECREATION COMMISSION

Proposed Budget for 1954

	<u>1953</u>	<u>1954</u>
Hockey Equipment & Supplies	\$ 250.00	\$ 350.00
Basketball	75.00	50.00
Figure & Speed Skating	100.00	75.00
Health & Recreation Classes	200.00	150.00
Boxing	50.00	35.00
<u>Outdoor Rinks:</u>		
Construction & Levelling	300.00	200.00
Maintenance	3,250.00	3,500.00
Water	800.00	1,100.00
<u>Boarded Rink:</u>		
Caretaking	950.00	1,550.00
Heat	120.00	150.00
Lighting	60.00	100.00
Truck (for rink & Playgrounds)	510.00	700.00
<u>Playgrounds:</u>		
★ Supervisors' Wages	1,500.00	2,200.00
Supplies	300.00	350.00
Maintenance	650.00	750.00
Moving playground	200.00	200.00
Maintenance ball fields	400.00	300.00
Supervision of Maintenance	706.00	700.00
Repairs to Equipment	150.00	150.00
Baseball & Softball supplies	200.00	150.00
Swimming expense	100.00	50.00
Track & Field	100.00	75.00
Rugby Football	100.00	50.00
Tennis Grant	100.00	100.00
Office Supplies & Telephone	300.00	325.00
Car Allowance & Travel Expense	650.00	750.00
Sundries	900.00	900.00
Friendship Club		200.00
	<u>\$13,021.00</u>	<u>\$15,210.00</u>

- ★ Most of increase of \$700 in this item is created by need for senior supervisor to train and direct playground supervisors. A trained person in recreation or university student in physical education and recreation would be desirable type. In order to obtain such it would be necessary to hire them for months of May, June, July and August.

Budget does not include figures for removal of outdoor rinks to new site. As this is a capital expense the query has risen as to whether such should be included in the Recreation Budget. Preliminary figures for change of site run as high as \$4000.00. Rink sites have to be levelled. Shack has to be moved (should be enlarged to twice its size), plumbing, lights etc. re-installed. It is planned to have Mr. Cole look over the proposed site to give us more accurate figures.

C. Jarvis Miller
Secretary.

Less 10% taxes *Map*

Signs { 25.00 3000 sq ft lighting 15.00 Sub - Highway
5.00 off main lighting

LEASES & RENTALS

Lessee	Purpose of Lease	Legal Desc.	1953 Ass- ed Value	1954 Ass- ed Value	1954 Sale Value	Rental Suggested 1953 1954	Mos. Owing 1953 1954	Formal Letter or Card	Expires
R.W. Prender- gast	Machinery yard	Lots 3 & 4 Blk. 5, Pl. K (Minneapolis Molen)	\$2620	\$6410	\$10,250	\$39.00 <i>Mill Rate</i>	nil	3 mo. Rental Card	Yearly expired
R.D. Co-op	Parking for store	S ² -7 all 8, Blk. 15, Pl. K.	2065	4385	7,020	10.00 <i>Mill rate</i> per mo.	nil	3 mo. 1954 at mill rate approx. \$600 per yr. lease to be drawn up	
R.J. Rollis	Sign	S. Hill by Thulls	---	---	---	5.00 - <i>25.00</i>	nil	3 mo. Rental Card per yr.	
R.J. Rollis	Sign	N.R.D.	---	---	---	10.00 - <i>15.00</i>	nil	3 mo. Rental Card per yr.	
<i>Trailer -</i> D. Snider	Picnic grounds	Pel G, 2178 HW (near Auto Court around town	1000	1420	2,270	1.00 <i>7.00</i>	nil	3 mo. By-law June 1960	
H. Spellman	10 Billboards		---	---	---	10.00 <i>25.00</i>	nil	3 mo. Rental Card per yr.	
Mrs. F. Ste- wart	Hse. site	Pt. N.E. 17- 38-27-4 (W. C.P.R. near Roundhouse)	250 per acre	750 per acre	1800 per lot as Industrial sites	35.00 <i>Mill rate</i>	nil	3 mo. Formal Tenant owns hse.	
Dr. Walton	animal Run	Lots 3-11, Blk. C, Pl. 2496 AQ	1275	2475	391	2.25 <i>12.00 125</i>	nil	3 mo. Per yr.	
Buffalo Hotel	Sign	N.R.D.	---	---	---	15.00 <i>15.00</i>	nil	3 mo. Rental Card per yr.	
Peacock Inn	Sign	N.R.D. - <i>3 R.D. -</i>	---	---	---	25.00 <i>25.00</i>	nil	3 mo. Rental Card per yr.	
R.D. Motors	Sign	N.R.D.	---	---	---	10.00 <i>15.00</i>	nil	3 mo. Rental Card per yr.	
H. Bowers	Hay	S. Hill	40 per acre	1500 <i>per</i> acre	720 per lot	1.00	nil		Expired
<i>Barren land - full</i> MacDonald Farm	machinery Equip. lot	Lots 3 & 4, Blk. 6, Pl. 6712 ET	810	2810	4500	Taxes <i>Mill Rate</i>	nil	3 mo. 60 days (indefinite)	
R.L. Dale	warehse. on C.P.R.	Pt. S.E. 17	1000	1800	2880	1000 assessment at mill rate	nil	3 mo. 60 days (indefinite)	
Alta. Gov't. Telephones	Pole rent	around Town	---	---	---	321.60 60¢ per pole	6 mo.	3 mo. Rental Card pay in May	

Lessee	Purpose of Lease	Legal Desc.	1953 Ass- ed Value	1954 Ass- ed Value	1954 Sale Value	Rental 1953	Suggested 1954	Mos. Owing 1953	Owing 1954	Formal Letter of Card	Expires
Alta. Gov't Telephones	Easement	Near 55 St.	---	---		1.00	<i>1.00</i>	6 mo.		Rental Card	
D.W. Ainge	Pasture	Blk. F, Pl. 6900 V (West Park not serviced)	3200	2420	3870	7.00 per yr.	<i>50¢/lot</i> 7.00	nil		3 mo. pay in May	30 days notice
W. Arb	Garden Plot	Lots 4 & 5, Blk. 4, Pl. 7604 S, N.R.D. not serviced	260	440	705	2.00	2.00 ✓	nil			any time if sold
<i>BK C</i> Bettenson Ctge. Co.	Gravel stock pile	Pcl. B Pl. 2219 HW West of Standard Motors	1170	2570	4110	36.40 (assessed value x millrate)	<i>Mill Rate</i> 36.40	nil		3 mo. Formal lease	30 days notice
Boy Scouts	Scout Hall	Lot 1, Blk. 48, Pl. 6990 ET	1200	1200	1920	1.00	1.00 ✓	nil		3 mo. Rental Card	Indefinite
Girl Guides	Guide Hall	Lot 2, Blk. 48, Pl. 6990 ET	600	930	1490	1.00	1.00 ✓	nil		3 mo. Rental Card	Indefinite
C.K.R.D.	Transmitter site	Pt. of S.W. 4-9	40 per acre	1500 per acre	720 per lot	123.50	<i>123.50</i>	nil		Pd. up formal to Apr. 15th.	Apr. 1959.
P. Crawford	used car Lot	Lot 9 & S. 23' Lot 10, Blk. 12, Pl. K.	2380	5310	8490	79.38	<i>Mill Rate</i>	nil		3 mo. formal	30 days notice
Curling Club	Rink	Lots 25-33, Blk. 29, Pl. K.	3375	3850	6195	10.00	<i>10.00</i>	10.00		formal	expired
Griffs Taxi	Taxi stand	Pt. of St. ? intersection Ross & 51 Ave.	?	5000 per ac. This is street	?	60.00	<i>30/month</i>	nil		3 mo. formal	Jan. 31/54
W.B. Kanten	workshop	Lot 9, Blk. 48, Pl. 6990 ET (near cor- onation Park)	650	880	1410	37.70	<i>7000</i>	nil		3 mo. letter	1970
J.P. Loxam	pasture	Lots in Blk. 4, 8509 ET (West Park)	2115	2000	3200	5.65	<i>700</i> <i>50¢/lot</i>	nil		3 mo. Rental Card	anytime if needed

Lessee	Purpose of Lease	Legal Desc.	1953 Ass- ed Value	1954 Ass- ed Value	1954 Sale Value	Rental 1953	Suggested 1954	Mos. Owing 1953	Owing 1954	Formal Letter or Card	Expires
MacDonald Farm Equip.	machinery Lot	1 & 2, Blk. 6, Pl. 6712 ET	795	2420	3870	32.28	Mill Rate	nil	3 mo.	formal	expired
Mrs. E. Mac- Lachlan	hse.site	Pt. of Lot 18, Blk. F, Plan K.9	275	1000	1600	15.00	15.00	nil	3 mo.	rental card	for nat- ural life Council by- law.
N.W. Utilities	Regulator Stn.	E.20' Blk. B, Pl. 2427 B0 (near Horne & Pit- field)	185	185	300	5.00	5.00			Rental Card	May 31/54
N.W. Utilities	Radio transmi- tter	Lots 27 & 28, Blk. 12 P. 3586 AE	250	480	770	25.00	25.00			formal	expired
C.P.R.	Pole ren- tal		---	---		9.60	9.60	nil	3 mo.	agree- ment	per yr.
C.P.R.	"Y" track	Pt. of S $\frac{1}{2}$ 17-38-27-4	250	750	1800 as Industrial Lots	9.48 per yr.	9.48	3 mo.	3 mo.	Formal	Oct. 1, 1960

Move → Pop Corn Stand - ~~move it.~~

By-Law ^{amend} 1435

License
+

1.00
per sq. ft.

ground rental of 7.50 / billboard of 25 ft or less
3.5 / " over 25 ft.

ground
lease

① Spellman

② Gordon lots

2.00

50¢/lot - outside

③ Sign -

25.00
15.00
5.00

By-law
2
fullman

④ Date April 1/54